

ASSEMBLY INSTRUCTION

MODEL: CF 8683 (6)

Step 1 : Tighten the legs (D) to both headboard (A) and footboard (B) as shown.

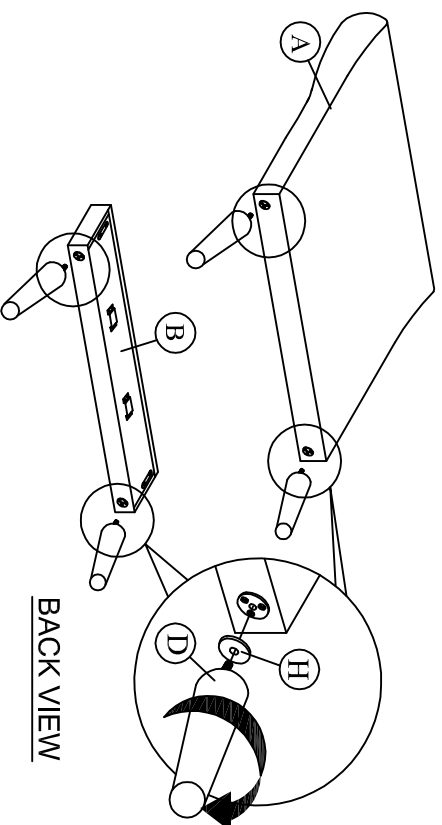

BACK VIEW

Step 2: Attach side rail (C) to headboard (A) and footboard (B) by pushing the bracket down to fit it.

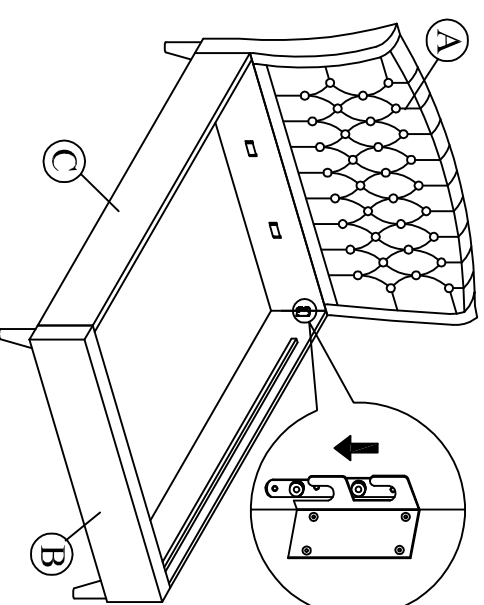

Step 3: Attach the support legs (F) to the center rail (E) of the bed as shown.

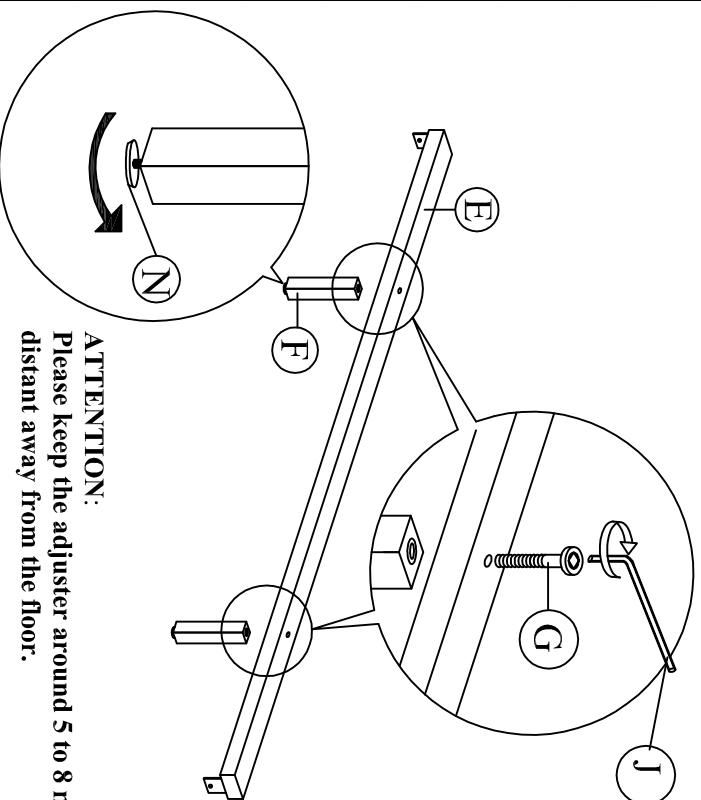

ATTENTION:
Please keep the adjuster around 5 to 8 mm distant away from the floor.

Step 4: Slide the center rail (E) to the headboard (A) and footboard (B). Tighten screws (K) using screw driver (not included) to the headboard (A) and footboard (B).

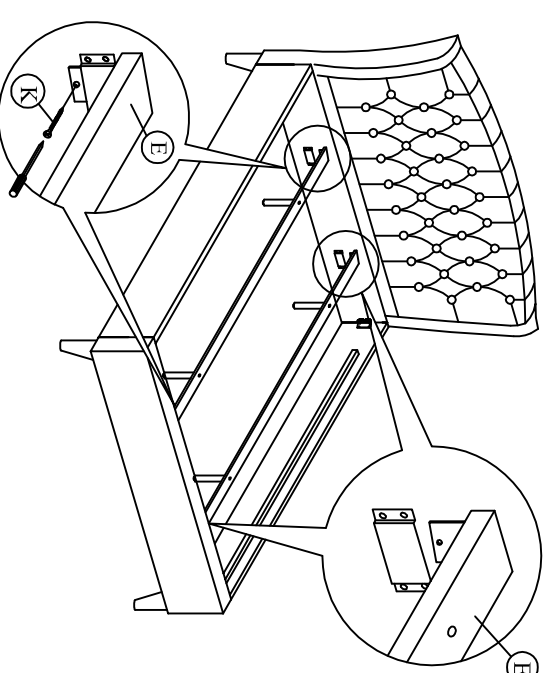

A	Headboard	1 pc
B	Footboard	1 pc
C	Side Rail	2 pcs
D	Leg	4 pcs
E	Center Rail	2 pcs
F	Support Leg	4 pcs
G	JCRC M6 X 40	4 pcs
H	NO 35 Washers	4 pcs
I	M5 x 70mm	1 pc
J	M4 x 65mm	1 pc
K	CSK M4 x 25mm	4 pcs
L	CSK M4 x 22mm	38 pcs
M	16 pcs Slat	1 pc
N	Adjuster	4 pcs

Step 5: Affix the Slat (M) to the side rail support wood and the center rail (E). Tighten all the 4 corner.

