

ASSEMBLY INSTRUCTIONS

KF.2701C Chicago/Mayfair



CAUTION:

Do not attempt to assemble or lift this product with only one person. Please use two people for your safety.



HARDWARE LIST		
ITEM	DESCRIPTION	QTY
1	plastic spacer	1
2	spring washer	4
3	middle leg	1
4	cotton pad	5
5	side leg	4
6	zinced spacer	4
7	screw	4
8	allen key	1
9	dowel	4

PRODUCT CARE

Protect from direct sunlight, direct heat and weather.

Covers will fade over time.

Do not remove covers for cleaning.

Blot food and liquid spills immediately with a dry, white, clean cloth. Do not rub.

Fabric product: Vacuum regularly using low suction.

If further cleaning is required, use a mild non-coloured pure soap solution made from soap flakes mixed with warm water.

Leather product: Vacuum regularly with a soft brush attachment.

Wipe clean with a damp colour-fast cloth.

Use only leather care products suitable semi-aniline leather and strictly in accordance with the manufacturer's instructions.

Professional cleaning recommended for persistent stains.

Dry in shade away from direct heat and sunlight.

Allow to dry thoroughly before use.

STEP 1:

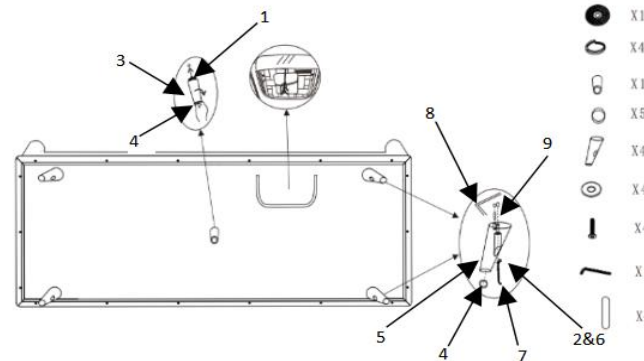

Unzip pocket and remove legs pack. Tighten legs to 80% to start.

When all parts have been assembled, you may fully tighten the hardware. To prevent damage to screw threads, do not use a power tool and do not over-tighten bolts.

STEP 2:

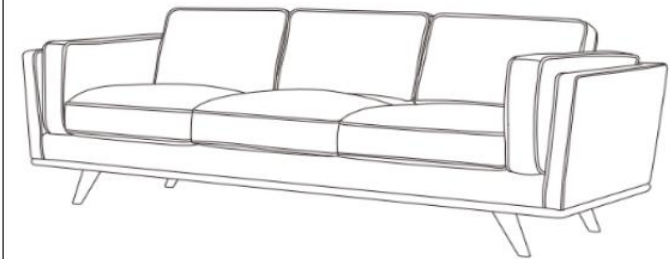

Gently flip over the sofa. It is important that you do Not roll the sofa onto the legs as this will weaken the structure. Assembly is now complete!